

215-221  
Louisa St. E

2371 Franklin E.  
Residence

2369 Franklin E.  
Residence

2365 Franklin E.  
Residence

2359 Franklin E.  
Residence

2355 Franklin E.  
Residence

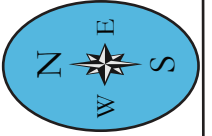

Enter

← (Alley Way) →

- Culver 406 (56)
- Kovalchick 225 (57)
- Leslie Ch. 319 (58)
- Acup. Health 237 (59)
- Marty 426 (60)
- Lifespan 314 (61)
- Kate C 424 (62)
- Lifespan 314 (63)
- Tom Lynch 203 (64)
- Vajra 239 (65)
- Felazzo 416 (66)
- Angelicka 208 (67)
- Egerton Crowel 236 (68)
- SBK 301 (69)
- Davies 420 (70)
- Pacadee 324 (71)
- Voter Action 311 (72)
- Brooks 321 (73)
- Brooks 321 (74)
- Severson 412 (75)
- Triple Creek 215 (76)
- Suryo 435 (77)
- Severson 412 (78)
- EMG 325 (79)

← Upper Parking →

- Hunt 235 (92)
- Hypno. Seattle 214 (91)
- Available (90)
- FSFP 311 (89)
- Picadee 324 (88)
- Urban Prop. 224 (87)
- Handi-Cap (86)
- Management (85)
- Natasha 333 (84)
- Jo L. F. 232 (83)
- National Solar 331 (82)
- C3 Research 312 (81)

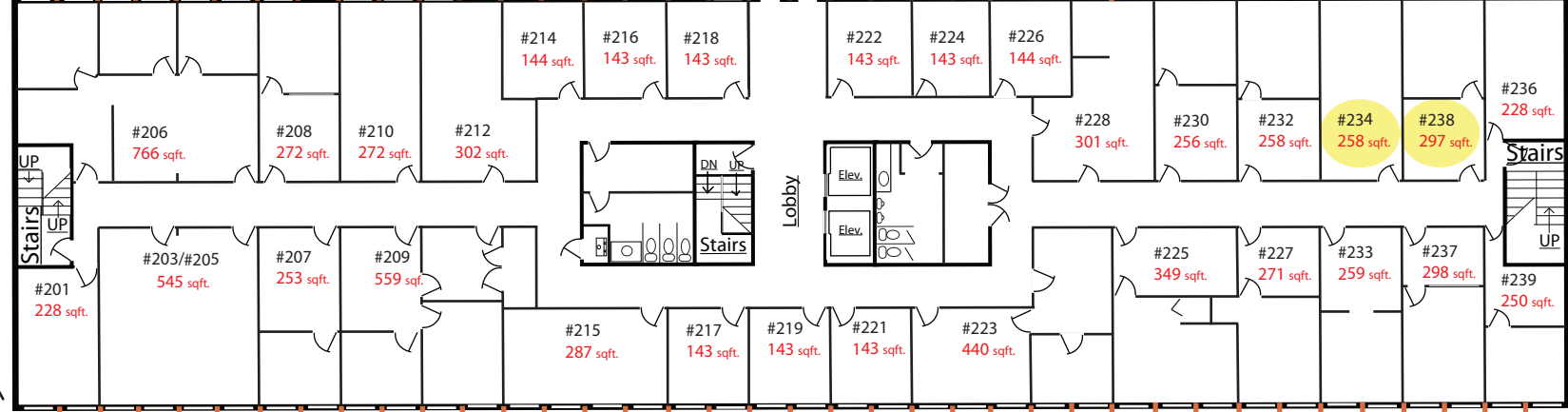

← Sidewalk (below) →

← Eastlake Ave East (below) →

↑ Louisa St. ↓

2nd FLOOR

# Areis Building

2366 Eastlake Avenue East Seattle, WA. 98102

Drawing by Haley Kostocke

2/2/2012 Gross Measured Area -- 11,497 SQ.FT.